

# PLASMA CB 70 P



## COMPLETE TORCH

| Pt. No. | Description                                    | Pack | Euro   | D |
|---------|--|------|--------|---|
| PA1290  | Plasma CB 70P machine torch 6m                 | 1    | 240,00 | B |
| PA1291  | Plasma CB 70P machine torch 6m central adaptor | 1    | 270,00 | B |

## TECHNICAL DATA

|                          |                  |
|--------------------------|------------------|
| <b>Voltage class</b>     | <b>M</b>         |
| <b>Standard length m</b> | <b>6</b>         |
| <b>Air consumption</b>   | <b>170 l/min</b> |
| <b>Air pressure</b>      | <b>5 bar</b>     |
| <b>Duty cycle 60%</b>    | <b>70 A</b>      |
| <b>Duty cycle 100%</b>   | <b>50 A</b>      |

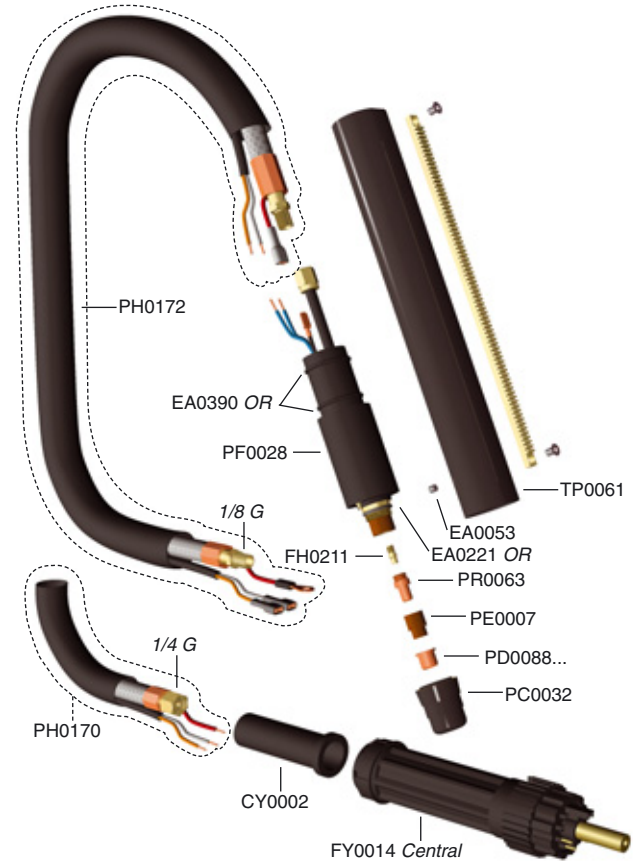
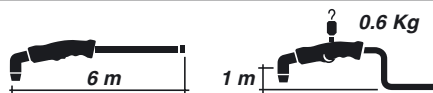

| Pt. No.   | Description                       | Pack | Euro   | D |
|-----------|-----------------------------------|------|--------|---|
| CY0002    | Cable Support                     | 1    | 1,10   | B |
| EA0053    | Screw                             | 50   | 0,10   | B |
| EA0221    | O-ring                            | 10   | 0,55   | A |
| EA0390    | O-ring                            | 10   | 0,50   | B |
| FH0211    | Diffuser 3065204                  | 1    | 2,50   | B |
| FY0014    | Male central adaptor 7 pins       | 1    | 31,50  | A |
| PC0032    | Outside nozzle (57110171)         | 2    | 6,00   | A |
| PD0088-10 | Tip Ø 1,0 long life CB 50 / 70    | 10   | 0,85   | A |
| PD0088-11 | Tip Ø 1,1 long life CB 50 / 70    | 10   | 0,85   | A |
| PD0088-12 | Tip Ø 1,2 long life CB 50 / 70    | 10   | 0,85   | A |
| PE0007    | Air diffuser HY 40 / CB 50        | 2    | 7,50   | A |
| PF0028    | Torch head CB 70P                 |      | 105,00 | A |
| PF0029    | Torch head CB 70P (1349) Old Type | 1    | 105,00 | A |
| PH0170    | Cable assembly 6m central adaptor | 1    | 100,00 | B |
| PH0172    | Cable assembly 6m 1/8 G           | 1    | 80,00  | B |
| PH0217    | Outer cover 6m steel              | 1    | 155,00 | C |
| PR0063    | Electrode - Hf. CB 70 (1402)      | 10   | 1,20   | A |
| TP0061    | Handle                            | 1    | 75,00  | B |

## NEW

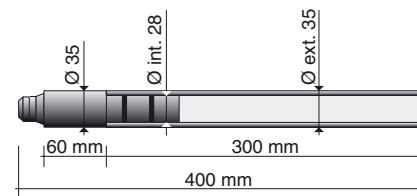

## OLD

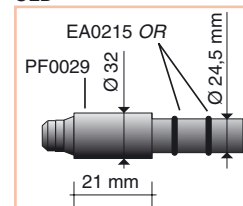

Plasma Range

trafimet®